



# MKE 600

Instruction manual

**SENNHEISER**

# Important safety instructions

1. Read these safety instructions and the instruction manual of the product.
2. Keep these safety instructions and the instruction manual of the product. Always include all instructions when passing the product on to third parties.
3. Only use attachments, accessories and spare parts specified by the manufacturer.
4. Caution: The protective basket and pop shield must be completely dry when you mount them on the microphone. Moisture can cause malfunctions or damage to the capsule.
5. Connect the microphone only to microphone inputs and supply units that provide 48V phantom powering in accordance with IEC 61938.
6. Do not attempt to open the product housing on your own. The warranty is voided for products opened by the customer.
7. Refer all servicing to qualified service personnel. Servicing is required when the product has been damaged in any way, liquid has been spilled or objects have fallen into the product, when the product has been exposed to rain or moisture, does not operate normally, or has been dropped.
8. Use the product only under the conditions of use listed in the specifications.
9. Let the product come to ambient temperature before switching it on.
10. Do not operate the product if it was damaged during transportation.
11. Always run cables so that no one can trip over them.
12. Keep the product and its connections away from liquids and electrically conductive objects that are not necessary for operating the product.
13. Do not use any solvents or aggressive cleaning agents to clean the product.
14. Caution: Very high signal levels can damage your hearing and your loudspeakers. Reduce the volume on the connected audio devices before switching on the product; this will also help prevent acoustic feedback.

## Intended use

The product is designed for indoor use.

It is considered improper use when the product is used for any application not named in the corresponding instruction manual.

Sennheiser does not accept liability for damage arising from improper use or misuse of this product and its attachments/accessories.

Before putting the products into operation, please observe the respective country-specific regulations!

## Delivery includes

- MKE 600 shotgun microphone
- MZS 600 shock mount
- MZW 600 foam windshield
- KA 600 adapter cable
- Instruction manual
- Storage pouch

## Delivery includes

- MZQ 600 microphone clamp
- MZH 600 “hairy” windshield
- KA 600i connection cable for mobile devices with 3.5 mm TRRS jack connection

For information on suppliers, contact your local Sennheiser partner:  
[www.sennheiser.com](http://www.sennheiser.com) > “Service & Support”.

## The MKE 600 shotgun microphone

The MKE 600 is the ideal video camera/camcorder microphone able to handle even demanding filmic challenges. Due to its high directivity, the MKE 600 picks up sounds coming from the direction in which the camera is pointing and effectively attenuates noise coming from the sides and rear. The switchable “Low Cut” filter additionally minimizes wind noise.



Because some video cameras/camcorders do not provide phantom power, the MKE 600 can also be battery powered. A battery on/off switch prevents the battery from discharging prematurely; “Low Batt” is displayed.

### Features

- Pronounced directivity
- Maximal rejection of side noise
- Switchable “Low Cut” filter minimizes wind noise
- Phantom or battery powering
- Battery switch with “Low Batt” indicator
- Rugged all-metal housing
- Very good suppression of structure-borne noise
- Supplied with foam windshield, shockmount and adapter cable for cameras with 3.5 mm jack connection

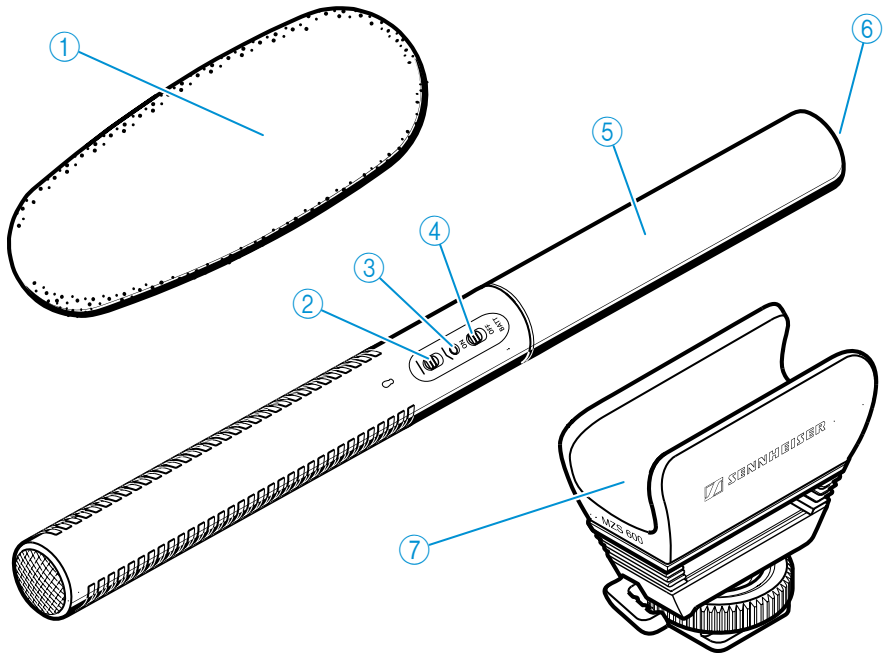
# Product overview



- 1 Foam windshield attenuates wind noise by approx. 25 dB
- 2 “Low Cut” switch  / 
- 3 LED operation indicator
- 4 BATT ON/OFF battery switch
- 5 Lower part of the microphone body (covers the battery compartment)
- 6 XLR-3 socket (male)
- 7 Shock mount with flash mount adapter

# Putting the MKE 600 into operation

The MKE 600 offers a choice of phantom powering via the XLR connection or internal battery powering.

## P48 phantom powering via XLR connection

- ▷ Connect the XLR-3 socket (female) of the microphone cable to the XLR-3 socket (male) of the microphone **8**.
- ▷ Connect the connector of the microphone cable to the video camera/cam-corder or recording device. The LED **3** provides the following information:

LED	P48 phantom powering
grün	switched on; the microphone is operational

**i** If phantom powered via the XLR connection, the microphone is continuously in operation (the **BATT ON/OFF** battery switch has no function).

## Internal battery powering

- ▷ Unscrew the lower part of the microphone body **5** by turning it in the direction of the arrow.
- ▷ Insert a battery/rechargeable battery (AA size, 1.5 V/1.2 V). Observe correct polarity when inserting the battery.
- ▷ Screw the lower part of the microphone body **5** back to the microphone by turning it in the direction of the arrow.

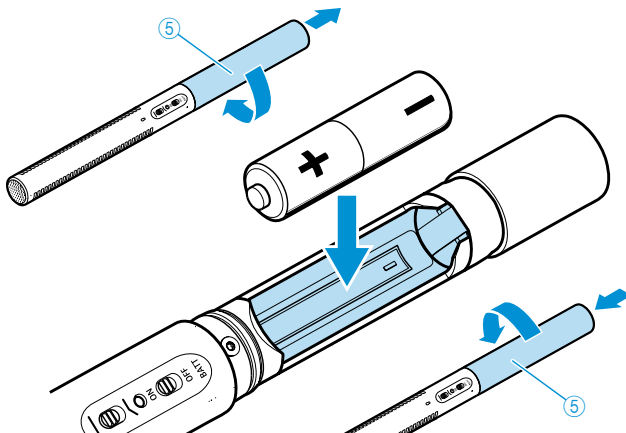

- ▷ Set the battery switch **4** to **ON** to switch the internal battery on or set the battery switch to **OFF** to switch the battery power off.

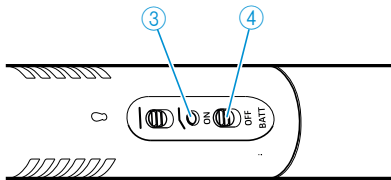

The LED **3** provides the following information:



LED	Internal battery power
lights up red for approx. 1 second after switch-on and then goes off	switched on; operating time: up to approx. 150 h
lights up red permanently	“Low Batt”, battery is almost empty; approx. 8 h of remaining operating time after initial display
flashes briefly red on switch-on	battery is empty; the microphone is not operational

- i** When not using the microphone for extended periods of time, remove the battery to prevent self-discharge.

## „Low Cut“ verwenden

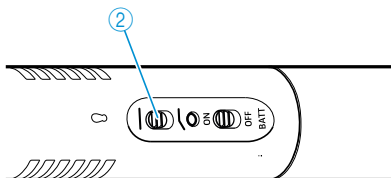
- ▷ Set the “Low Cut” switch **2** to the desired position.

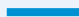

Switch position	Frequency response of the microphone
	linear frequency response
	frequencies below 100 Hz are attenuated to reduce wind and impact noise

# Cleaning and maintaining the MKE 600

---

## CAUTION

### DAMAGE TO THE PRODUCT DUE TO LIQUIDS!

Liquids entering the product can short-circuit the electronics or damage the mechanics. Solvents or cleansing agents can damage the surface of the product.

▷ Keep all liquids away from the product.

---

▷ Only use a soft, dry cloth to clean the product.

## Technical data

Pick-up pattern	super-cardioid/lobar
Frequency response	40 Hz to 20 kHz
Sensitivity	with P48 powering: 21 mV/Pa with battery powering: 19 mV/Pa
Max. SPL	with P48 powering: 132 dB SPL with battery powering: 126 dB SPL
Equivalent noise level A-weighted	with P48 powering: 15 dB (A) with battery powering: 16 dB (A)
Power supply	48 V $\pm$ 4 V (P48, IEC 61938) via XLR-3 or battery/rechargeable battery (AA size, 1.5 V/1.2 V)
Current consumption	with P48 powering: 4.4 mA
Operating time with battery	approx. 150 h
“Low Batt” indicator	< 1.05 V; approx. 8 h of remaining operating time after initial display
Diameter	20 mm
Length	256 mm
Weight	128 g (without battery)
Operating temperature	-10 °C bis +60 °C

# Polar diagram

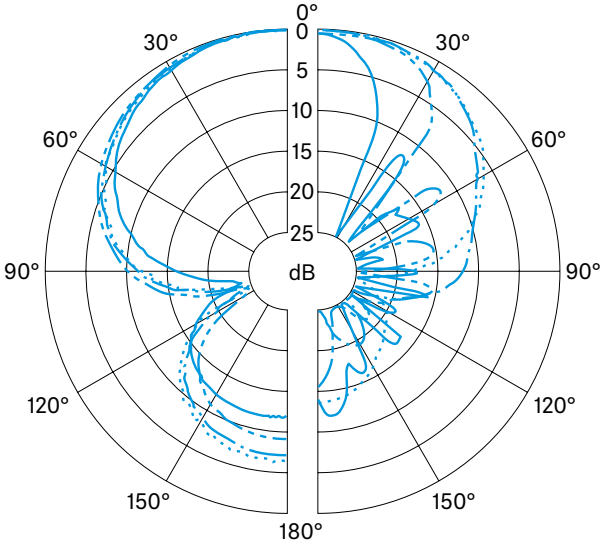

- 125 Hz    .....
- 2000 Hz    .....
- 250 Hz    -.-.-
- 4000 Hz    -.-.-
- 500 Hz    -.-.-
- 8000 Hz    -.-.-
- 1000 Hz    ———
- 16000 Hz    ———

# Frequency response curve

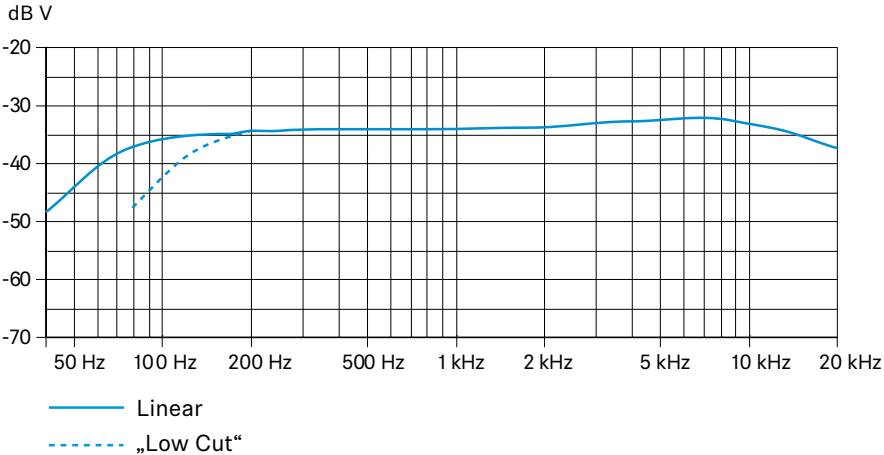





**Sennheiser electronic GmbH & Co. KG**

Am Labor 1, 30900 Wedemark, Germany, [www.sennheiser.com](http://www.sennheiser.com)  
Printed in Germany, Publ. 09/22, 536956/A02